

Sandal Making Machine

Am1, Am2, Am3, SET

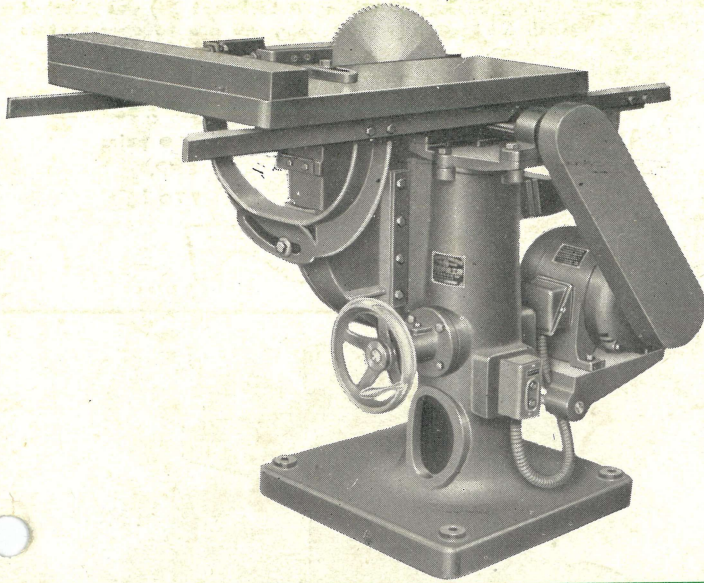

Circular Saw Bench S 17m

This machine works as the first process to cut material as Fig. ①, also to be used the former process of Side Forming Machine work as Fig ②

Specifications

Size of machine (W×L×H)	35"×47"×43"
Dia. of saw	16" - 18"
Capacity per hour	150~350pairs
Motor	2HP
Gross weight, approx.	300kg

Fig ①

Fig ②

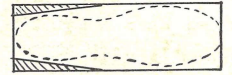
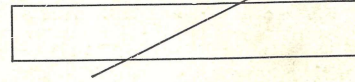

S 02-2m Automatic Tread Finishing moulder

S 02-2m is the combined machine of S01-3 S and S 02.

Simple to fix machine on factory at any place as it has electric motor drive.

The difference between S 02-2m and S 01-3m is that the former uses S 02 and the latter does not.

This machine also can be attached with Surface Moulding Attachment (XI) same as Automatic Tread Moulder.

The machine No. of Automatic Tread Finishing Moulder with Surface moulding attachment is S 02-2X1m.

Specifications

Size of machine (W×L×H)	40"×130"×50"
Capacity per hour	430pairs
Motor	5HP 2HP
Gross weight, approx.	1,800kg.

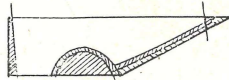
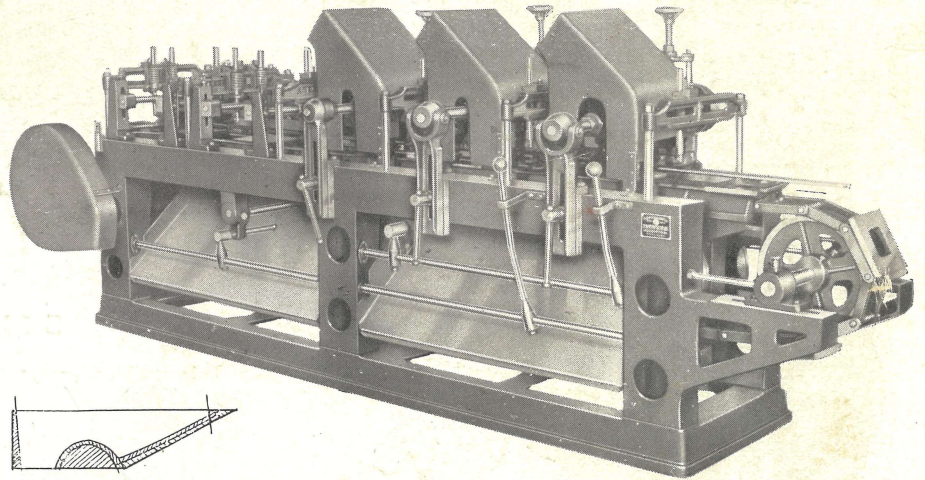

This part is surface moulding attachment=SOX I

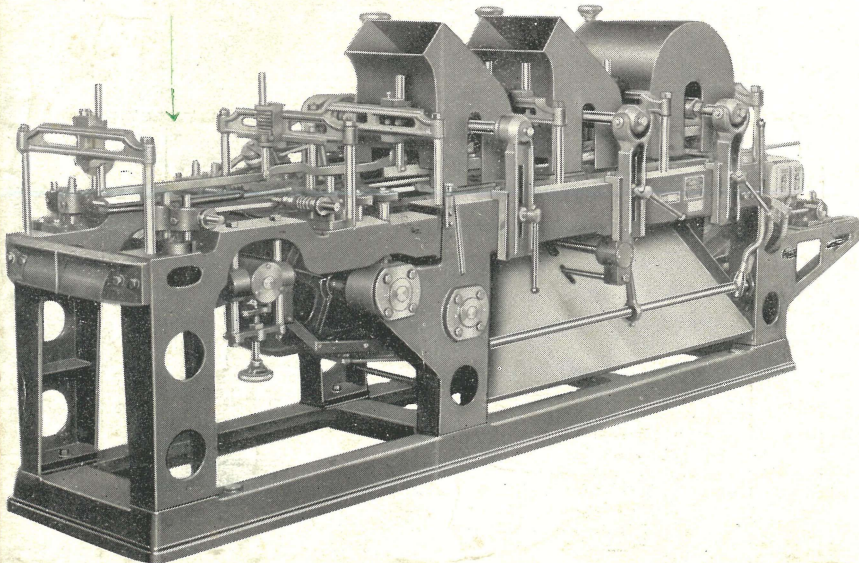

S 01-3SX1m Automatic Tread Moulder

Automatic Tread Moulder only can make Fig.1 but can not make Fig.2.

By attached Surface Moulding Attachment (XI), S 03m process can be done on same time.

(Fig.1 Fig.2 black marked port)

Specifications

Size of machine	40"×120"×50"
Capacity per hour	430 pairs
Motor	5HP 2HP
Gross weight approx.	1,600kg

Fig. 1.

Fig. 2.

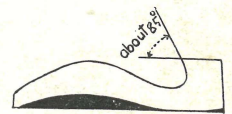
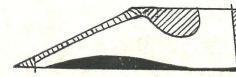

Can not work for less than 85°.

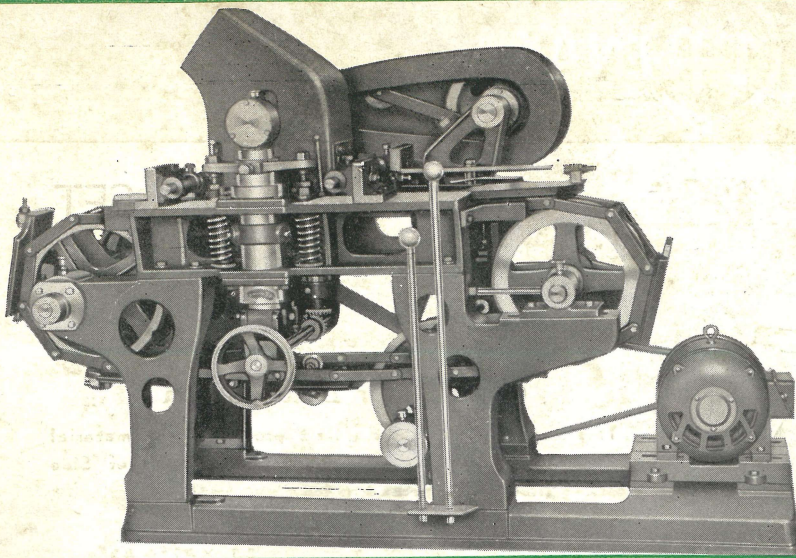

S 03 m Automatic Surface Moulder

This machine is used for the 3rd. process of sandal making. Timing with feed by a chain conveyer which carries the Material, the cutter spindle moves automatically up and down by a cam mechanism, so that the face of sandal may be cut and finished to any desired shape.

The shape of cam depends upon that of sandal to be worked.

When Surface Moulding Attachment (XI) was attached with SO2-3m or SO1-3m, no use to operate this machine.

Specifications

Size of machine (W×L×H)	25"×35"×28"
Capacity per hour	430 pairs
Motor	3HP.
Gross weight. approx.	770 kg



S 11 m Double Spindle Side Forming Machine

This machine is used for the 4th process of sandal making. With a guide templet it finishes the side face of sandal. Two spindle revolve in opposite direction each other, thus the machine does not cut against the wood grain. and fine finishing is obtained.

Specification

Size of machine (W×L×H)	25"×35"×28"
Capacity per hour	80~160 Pairs
Motor	2 HP.
Gross weight. approx.	215kg

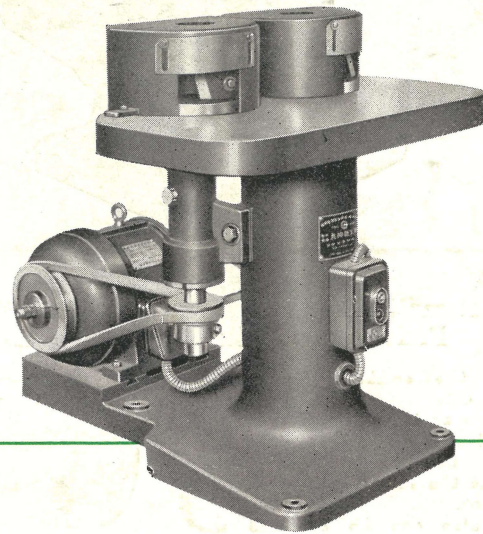

S 16 m Cutter Grinder

This machine grinds the cutter and the saw of these machines.

Specifications

Size of machine (W×L×H)	18"×10"×12"
Revolution (R.P.M.)	3,000~3,400
Motor	1/2HP, 200~220Volt

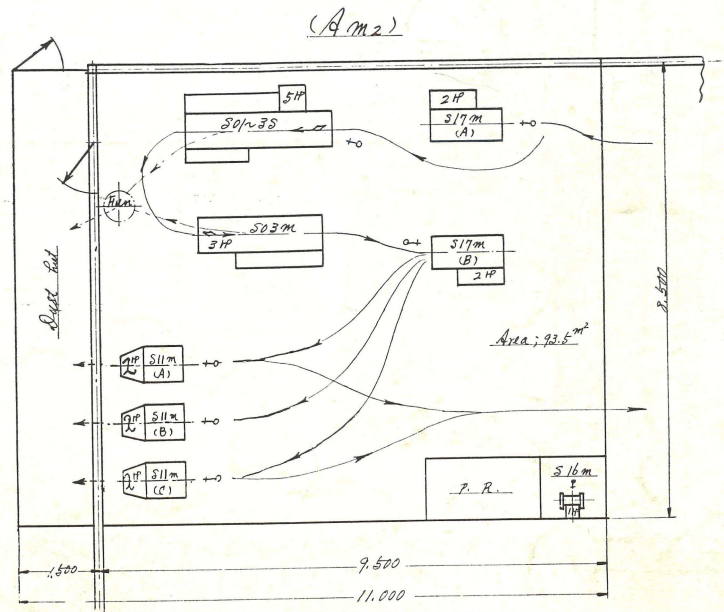
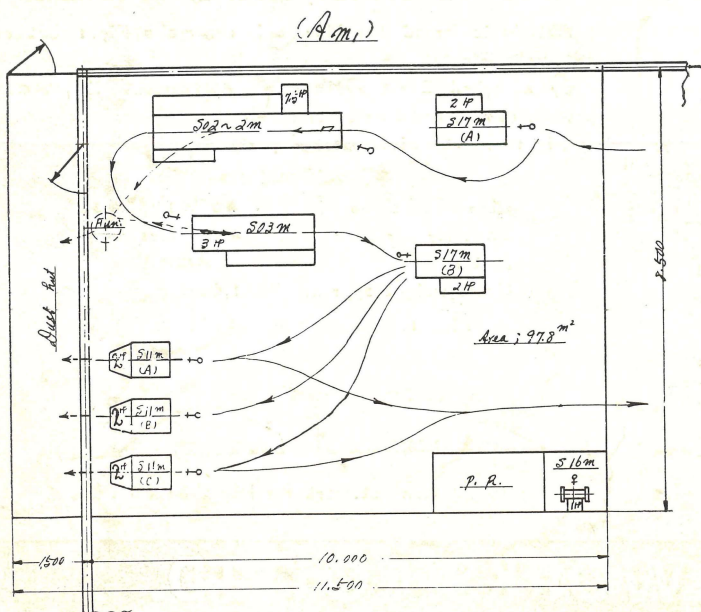
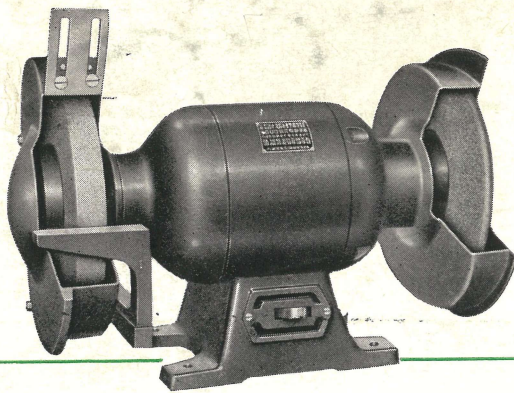

A1 A2 SET

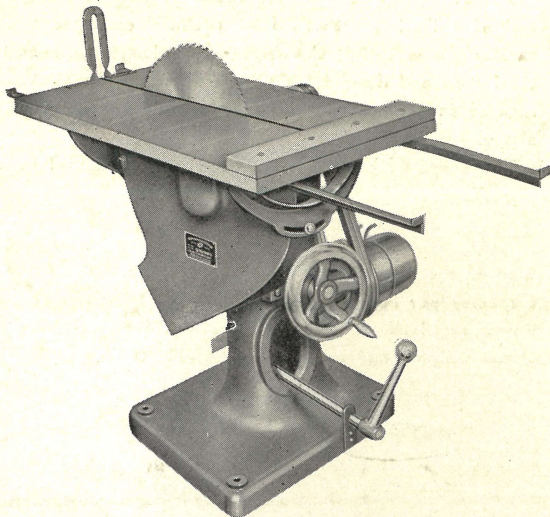

S 17 Circular Saw Bench

This machine works as the first process to cut material as Fig. ①, also to be used the former process of side Forming machine work as Fig. ②

Specifications

Size of machine (W×L×H)	35"×47"×43"
Dia. of saw	16" - 18"
Capacity per hour	150~350 pairs
Power required	1~2HP
Gross weight. approx.	245 kg

Fig ①

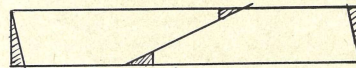

Fig ②



S 01~3 S Automatic Tread Rough-cut moulder

Automatic Tread Rough-cut Moulder only can make also but it's surface is a little rough, than that use with automatic Tread Finishing machine (S 02-1). It can make Fig. 1 but cannot make Fig. 2

Specification

Size of machine (W×L×H)	35"×98"×44"
Capacity per hour	430 pairs
Power required	5 HP
Gross weight. approx.	1,000 kg

Fig 1



Fig 2

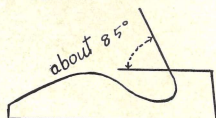

Can not works for less than about 85°.

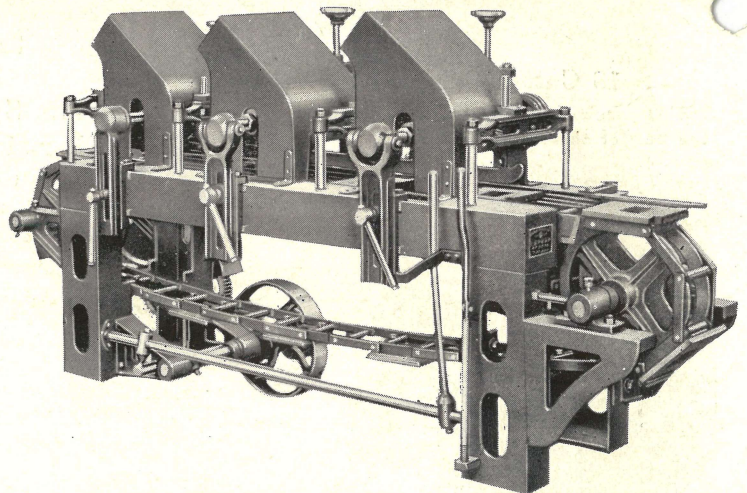

S 02~1 Automatic Tread Finishing Machine

Automatic Tread Finishing machine is used for finishing after used Rough cut moulder.

Finishing machine can finish all kind patterns which can not finish with Rough moulder.

For finish it's backside use fixed forming cutter. The process is as bellow sketch.

Specifications

Size of machine (W×L×H)	35"×75"×40"
Capacity per hour	430 Pairs
Power required	3HP
Gross weight. approx.	670 kg

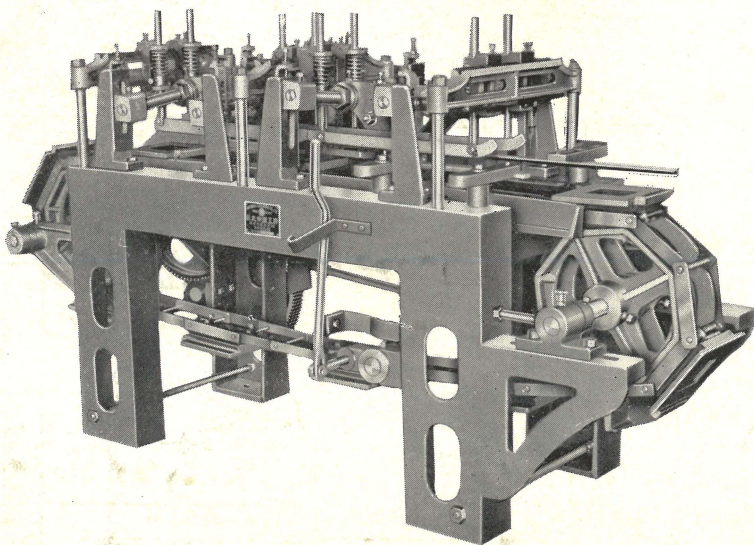

MARUNAKA IRON WORKS CO., LTD.

96, WAKAMATSU-CHO, SHIZUOKA,
JAPAN.

S 03 Automatic Surface moulder

A machine to be used for the 4 th process of sandal making. Timing with feed by a chain conveyer which carries the material, the cutter spindle moves automatically up and down by a cam mechanism, so that the face of sandal may be cut and finished to any desired shape.

The shape of cam depends upon that of sandal to be worked.

Specifications

Size of machine (W×L×H)	34"×60"×40"
Capacity per hour	430 Pairs
Power required	2 HP
Gross weight. approx.	690

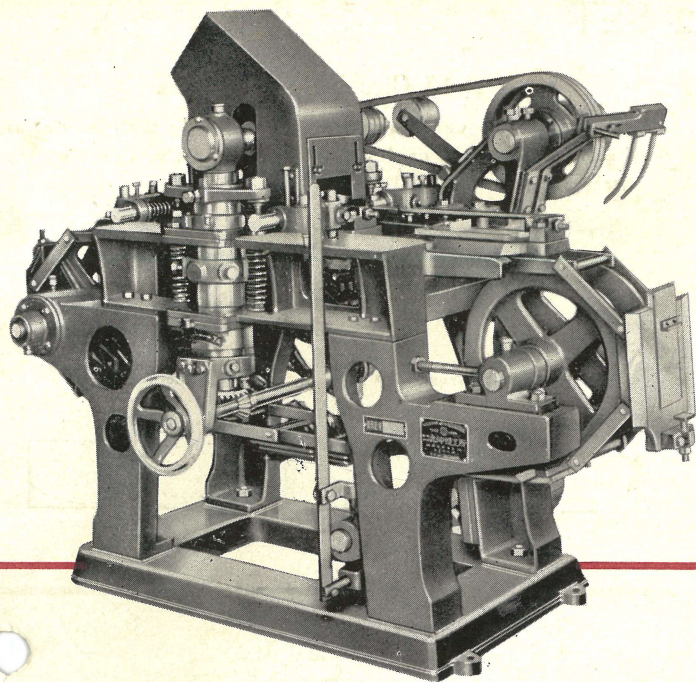

S 16 Cutter Grinder

This machine grind the cutter and the Saw of these machine.

Specifications

Size of machine	25"×14"×20"
Power required	1/2~1 HP
Gross weight. approx.	75 kg

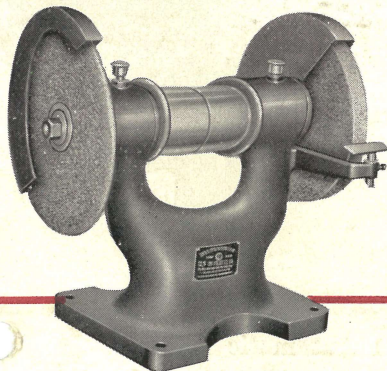

S 11 Double Spindle Forming Machine

This is used for the 5 th process of sandal making. With a guide templet, it finishes the side face of sandal. Two spindles run in opposite direction each other, thus the machine does not cut against the wood grain, and fine finishing is obtained.

Specifications

Size of machine (W×L×H)	25"×35"×28"
Capacity per hour	80~160
Power required	1~2 HP
Gross weight. approx.	200 kg

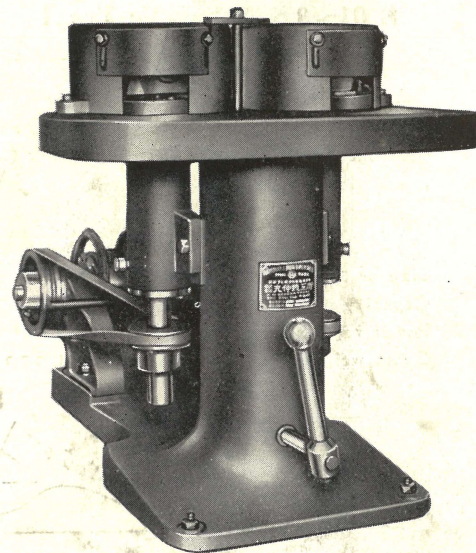

Lay out of factory

